

BALDOR® • RELIANCE™

Customer information packet 111

20C 2P BUFFER

Part detail

Revision	L
Type	AC
Mech. spec.	G7-0429
Base	
Status	PRD/A
Elec. spec.	G7WG0030
Layout	G7LY0429
Eff. date	06-23-2023
CD Diagram	CD0279
Poles	02
Leads	4#18
Proprietary	False
Created date	08-06-2018

Nameplate

NP3352L			
CAT.NO.	111		
HP	.33	VOLTS	115
PHASE	1	AMPS	4.2
HZ	60	RPM	3600
SER.NO			
SPEC.	G7-0429-0030G1		
BLANK			

Parts list

Part number	Description	Quantity
SA359418	SA G7-0429-0030G1	1.000 ea
RA348508	RA G7-0429-0030G1	1.000 ea
OC3006F12	CYL OIL CAP 6MFD/370V	1.000 ea
G7BA3000	G7-286 BASE DIE CAST	1.000 ea
WD4102A01	SR-6L-1 HEYCO STRN RELIEF OR 23MPO6L10 M	1.000 ea
WD1000A16	2-520128-2 AMP FLAG TERMINAL(4M/RL)	4.000 ea
11XW1032G06	10-32 X .38, TAPTITE II, HEX WSHR SLTD U	1.000 ea
HW3001B02	BRASS CUP WASHER W/GROUND SYMBOL TAB,	1.000 ea
SP9000SP	80600BJ A-H OR 1520237-2 TYCO;2PST,125/2	1.000 ea
HW1003A50	LOCKWASHER,1/2",EXT.TOOTHZINC PLATED	1.000 ea
G7CB4500	BASE COVER PLATE 7" GRINDER	1.000 ea
51XW1032A06	10-32 X .38, TAPTITE II, HEX WSHR SLTD S	2.000 ea
RM1005A01SP	BUMPER- #2089 (R-R CO)	4.000 ea
G7EP3900A04	ENDPLATE, MACH	1.000 ea
HW5100A03	WAVY WASHER (W1543-017)	2.000 ea
G7EP3900A04	ENDPLATE, MACH	1.000 ea
XY1032A02	10-32 HEX NUT DIRECTIONAL SERRATION	4.000 ea
HA6050A02SP	FLANGE, WHEEL, MACH	2.000 ea
HA6050A02SP	FLANGE, WHEEL, MACH	2.000 ea
HW3021C04	SPRG PIN 3/32 DIA .375LGH DRIV-LOK	1.000 ea
HW3021C04	SPRG PIN 3/32 DIA .375LGH DRIV-LOK	1.000 ea
XY5020A12SP	1/2-20 NUT R.H. HEX (NF)	1.000 ea
XY5020A62SP	1/2-20 NUT L.H. HEX (NF)X	1.000 ea
RM1010A17	VINYL CAP .812-16 701-89 BLACK	1.000 ea
51XN1032A07	10-32 X 0.438 HX WS SL SR ZN	2.000 ea
RM1010A17	VINYL CAP .812-16 701-89 BLACK	1.000 ea
XY1032A02	10-32 HEX NUT DIRECTIONAL SERRATION	2.000 ea
HA3100A29	THRUBOLT 10-32 X 7.00	4.000 ea
HA3205A50	U550-N SWITCH NUT/CARLING	1.000 ea
LD5001A11	6' cord w/115V plug 18-3 105C 300V B W G	1.000 ea
WD4006C05	ORANGE, WIRENUT, G-B #13-003 ORGSIZE 73B	2.000 ea

HA6053A01ZP	CLAMP, CAPACITOR 2" DIA, WHITE ZINC PLAT	1.000 ea
MG1000G01	MUNSELL 5.93PB 3.81/ 2.71	0.014 ga
85XU0407S04	4X1/4 U DRIVE PIN STAINLESS	2.000 ea
LB1009N	LABEL,ROTATION DIRECTION (ON ROLLS)	1.000 ea
LB1091	LABEL, WARNING BUFFERS	1.000 ea
MN906	Baldor Buffer 6/13	1.000 ea
LB1624	COMBINED WARNING LABEL, ISO/ANSI PICTOGR	1.000 ea
LC0279A01	1PH, DV, FIX, GRINDER, CONN FOR LV	1.000 ea
NP3352L	ALUM NAMEPLATE - BALDOR BUFFER NO LOGOS	1.000 ea
G7PA1014	PKG GRP, BLANK PK1034	1.000 ea
LB1618	PROPOSITION 65 WARNING LABEL 1-1/2 X 1/2	1.000 ea

Accessories

Part number	Description	Multiplier
GA16E	PEDESTAL LIGHT INDUSTRIAL,STEEL	A8
GA16	PEDESTAL INDUSTRIAL, CAST IRON 6" - 10"	A8
GA14	PEDESTAL FABRICATED STEEL W/SHELVES	A8
A65	6" COTTON BUFFING WHEEL 1/2" BORE	A8
BQ1-015-CC	1PH Brake, NEMA 1,110-125 VAC, 50/60Hz	
BQ1-015-CP	1PH Brake, Panel 110-125 VAC, 50/60 Hz	

G7LY0429

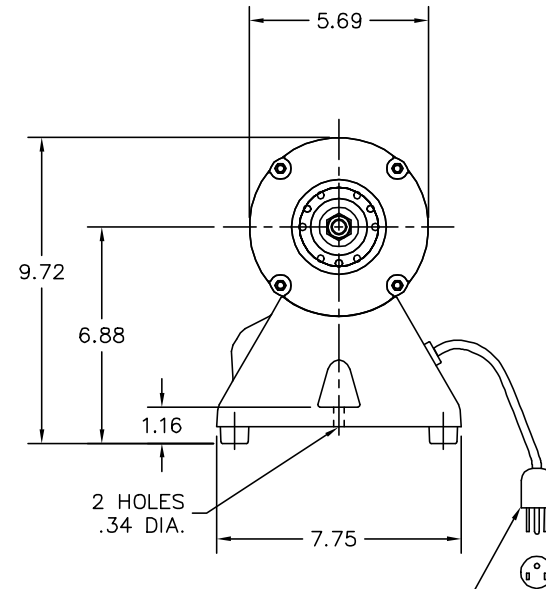
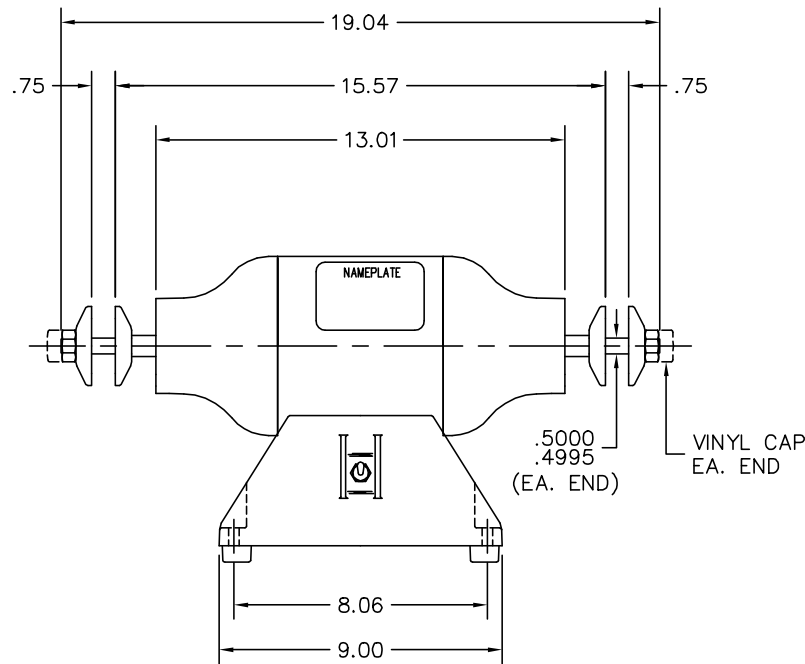

SEE SPL INSTRUCTIONS FOR CORD LENGTH

CUSTOMER IS RESPONSIBLE FOR DETERMINING THAT BALDOR'S PRODUCT WILL PERFORM SUITABLY IN THE INTENDED APPLICATION.

REV. DESC: NEW		
REV. LTR: -	VERSION: 00	TDR: 000001079698
FILE: \AAA\00244\395	REVISED: 04:31:41 08/06/2018	BY: ENMARHO
MTL: -	© □	

BALDOR - RELIANCE®

BUFFER 7" TYPE "C" - 115V W/SHAFT EXT FROM G6-209 (.50 DIA)

SH 1 of 1

G7LY0429

